

PLAT OF SURVEY
OF

PART OF SECTION 35, T. 1 N., R. 18 E. OF THE 4TH P.M., VILLAGE OF GENOA CITY, COUNTY OF WALWORTH, STATE OF WISCONSIN AND MORE PARTICULARLY DESCRIBED AS FOLLOWS: COMMENCE 4 RODS WEST OF THE NORTHWESTCORNER OF LOT 1, BLOCK 1 OF STRAIN'S ADDITION, THENCE SOUTH 10 RODS; THENCE WEST 4 RODS; THENCE NORTH 10 RODS; THENCE EAST 4 RODS TO BEGINNING.

ST. ADDRESS: 517-519 WALWORTH ST.

FOR: JABLONOWSKI

SCALE 1" = 30'

⊘ = IRON PIPE STAKE FOUND

○ = IRON BOLT SET.

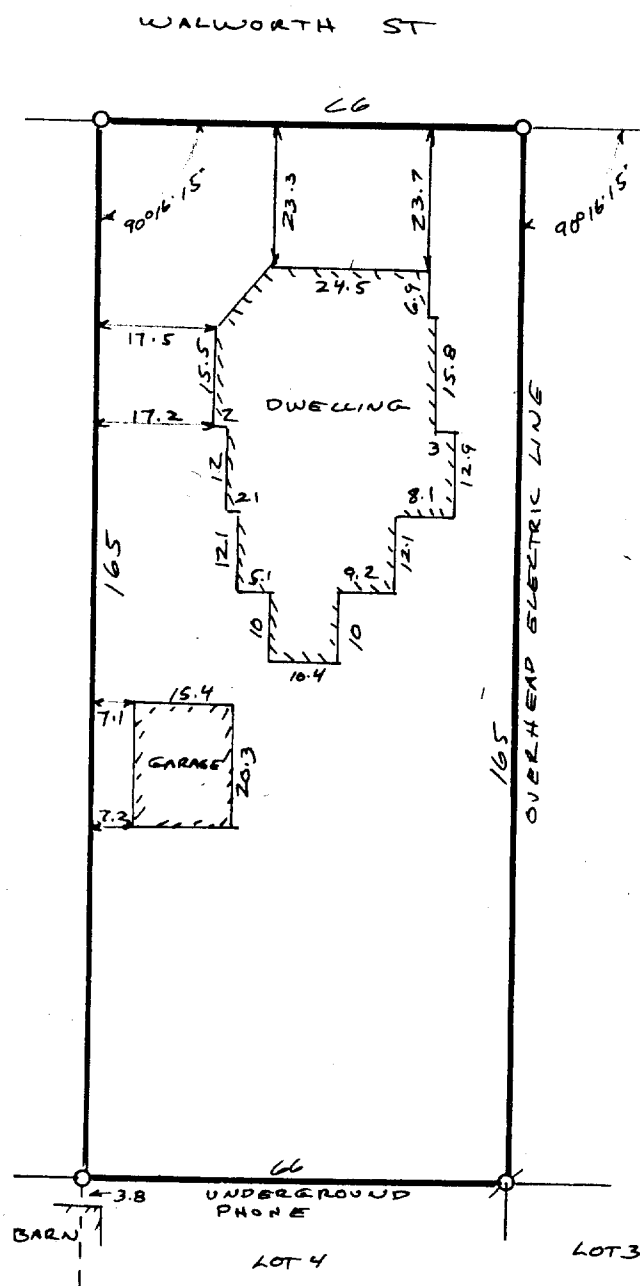
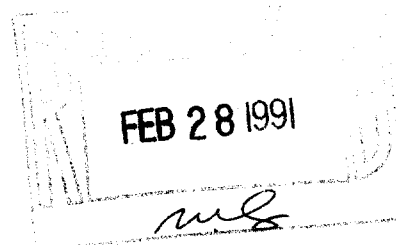

I have surveyed the above-described property, and a map hereon is a true and correct representation thereof and shows the size and location of the property, its exterior boundaries, location and dimensions of all visible structures, fences, apparent easements and encroachments and visible encroachments, if any.

This survey is made for the exclusive use of the present owners of the property, and also those who purchase, mortgage, or guarantee the title thereto, within one year from date hereof.

Dated at Burlington, this 30th day of December, 1990

John F. Degen
John F. Degen, Land Surveyor 6/242
589 N. Pine St. Burlington, WI 53105